

Please make sure to read the enclosed Ninja® Owner's Guide prior to using your unit.



QUICK START GUIDE

+ 10 IRRESISTIBLE RECIPES

BEFORE YOUR FIRST BREW

You'll need to prime your system by running two Full Carafe brew cycles, using only fresh water. With your brewer plugged in and powered on, fill the reservoir with fresh water up to, but not exceeding, the Max Fill line. Place the empty carafe under the brew basket, then select Full Carafe and Classic Brew.

When the first cycle is complete, discard the water in the carafe and repeat. After completing two water-only priming cycles, you'll be ready to brew delicious coffee.

HIGH-ALTITUDE CALIBRATION BREW

(Optional, but recommended for users in high-altitude areas.)

Because water boils at lower temperatures at higher altitudes, running a calibration cycle before your first brew allows the unit to detect the boiling point of water at your location. Refer to the **Owner's Guide** for instructions.

1 FILLING THE WATER RESERVOIR

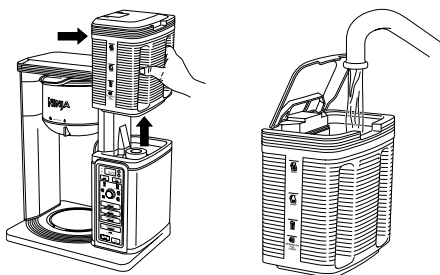

FILL TO THE MAX LINE

Fill up to, but do not exceed, the Max Fill line.

2 CUP, MUG, OR CARAFE

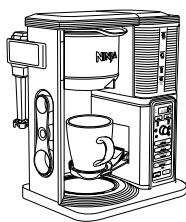

CUP

Pull down the cup platform to set your mug on it.

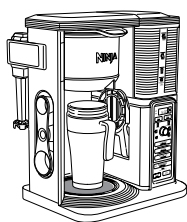

TRAVEL MUG & XL SIZES

Place your XL Cup, Travel Mug, or XL Tumbler on the base of the brewer.

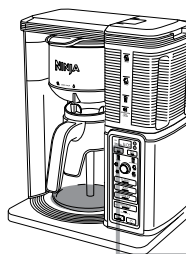

CARAFE

Place your carafe on the Intelligent Warming Plate.

The Intelligent Warming Plate will only turn on if brewing a Full or Half Carafe of Classic or Rich Brew.



WANT YOUR COFFEE TO STAY HOT LONGER?

You can program how long the Intelligent Warming Plate remains on (up to 4 hours) and/or set the temperature to High or Low. Refer to the **Owner's Guide** for instructions.

MANUALLY TURN OFF THE INTELLIGENT WARMING PLATE BY PRESSING STAY WARM AGAIN.

NOTE: The HOT SURFACE  indicator will illuminate when the warming plate surface is hot. The indicator will remain illuminated until the warming plate has returned to a safe temperature.

3 REMOVABLE FILTER HOLDER & FILTER OPTIONS

The filter holder removes for easy filling and quick cleanup. Place either a paper filter or permanent filter into the filter holder. To avoid spills and drips after a brew, keep the paper or permanent filter inside the filter holder as you carry it to the trash.

IF USING PERMANENT FILTER

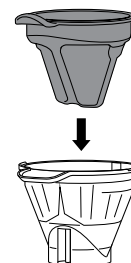

The permanent mesh filter is already in place in the filter holder—you can add your coffee directly to it.

IF USING PAPER FILTER

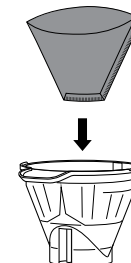

Remove the permanent filter, then fold a #4 paper cone filter along the seams and insert firmly into the filter holder.

4 DRIP STOP

CAN'T WAIT FOR THAT FIRST CUP?

Close the drip stop to pause the carafe brew cycle, and then pour yourself a cup. Reopen the drip stop to continue the brew.

STOP THE DRIPS AFTER A BREW

At the end of a brew, close the drip stop to prevent coffee dripping from the brew basket.

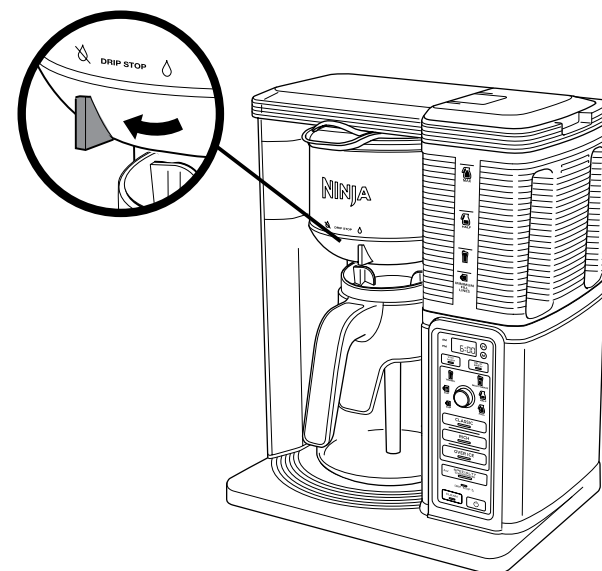

5 BREW STYLES

CLASSIC

Smooth, well-balanced flavor.

RICH

Richer than classic, with more intense flavor that really stands up to milk, cream, or flavoring.

OVER ICE

Specially designed to brew hot **over ice** for freshly brewed iced coffee that is not watered down.

NOTE: DO NOT use glassware. However, the provided Ninja® glass carafe is safe to use due to the specialized glass material used.

Always fill your vessel to the top with ice cubes before brewing Over Ice.

SPECIALTY (4 oz.)

A super-rich concentrate that allows you to make coffee-based drinks like cappuccinos and lattes.

6 THE BREWING PROCESS

HOW TO BREW CLASSIC, RICH, OR OVER ICE

1 CHOOSE A SCOOP

The Ninja Smart Scoop™ takes the guesswork out of measuring. The numbers beside the icons show the number of scoops recommended for each brew size.

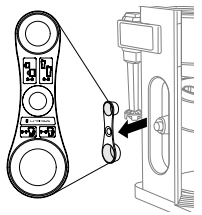

SERVING SIZE	NINJA SMART SCOOP
GROUND COFFEE	
	2-3 small scoops
	3-5 small scoops
	3-4 big scoops
	4-6 big scoops

2 CHOOSE A SIZE

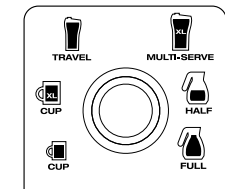

Place a cup/mug that is big enough for the brew size you've selected.

	CUP	9.5 oz.*
	XL CUP	11.5 oz.*
	TRAVEL MUG	14 oz.*
	XL MULTI-SERVE	18 oz.*

*Approximate brew volumes based on Classic Brew.

3 CHOOSE A BREW STYLE

Press your desired brew style button and the brew will begin.

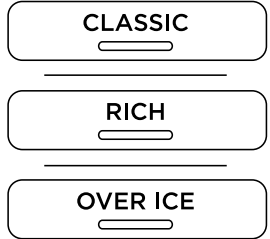

NOTE: Always fill your vessel to the top with ice cubes before brewing Over Ice.

THERE WILL BE A PAUSE. THAT'S OK. The pause is part of the pre-infusion cycle that unlocks the full flavor of your coffee.

SPECIALTY

1 CHOOSE A SCOOP

Use the big side of the scoop for SPECIALTY brew.

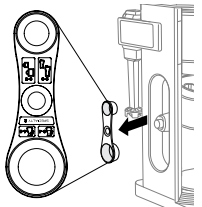

SERVING SIZE	NINJA SMART SCOOP™
GROUND COFFEE	
SPECIALTY	2 big scoops

2 NO NEED TO CHOOSE A SIZE

Specialty is always 4 oz. of coffee, so you don't need to select a size.

3 CHOOSE SPECIALTY

Press the SPECIALTY button and the brew will begin.



THERE WILL BE A PAUSE. THAT'S OK. The pause is part of the pre-infusion cycle that unlocks the full flavor of your coffee.

7 FROTHING

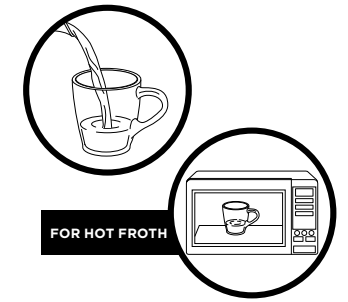

- Add milk to your cup until it is about 1/3 full.
 - ❄️ For cold froth, go to Step 2.
 - 🔥 For hot froth, microwave for 45-60 seconds.

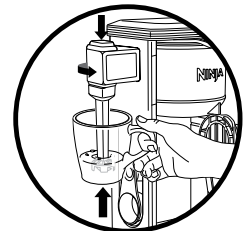

- Hold the cup under the frother and submerge the whisk just below the surface of the milk. Froth for 30-45 seconds.

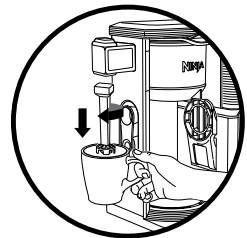

- Remove the frother whisk by twisting clockwise. Keep your cup below the whisk while you carry it to your sink or dishwasher for easy cleaning.

WARNING: To avoid contact with steam and hot surfaces, DO NOT reach across top of brewer to froth.

NINJA[®]

SPECIALTY
COFFEE MAKER

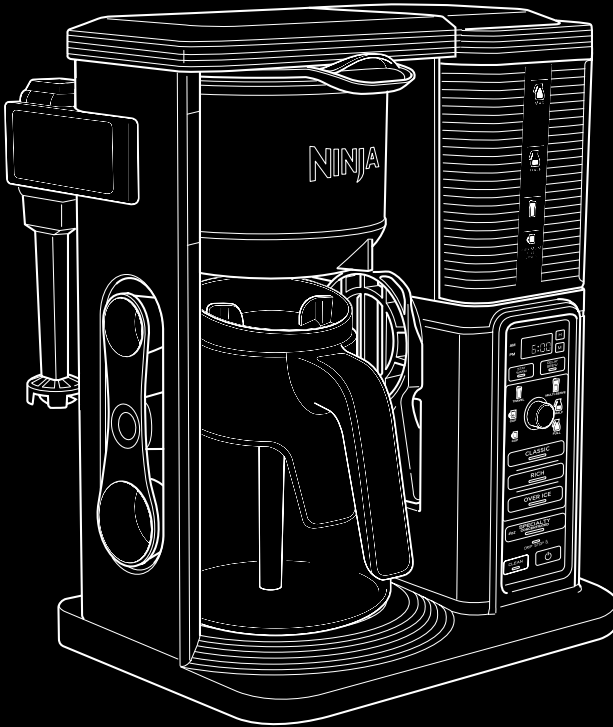

For questions or to register your product, contact us at
1-877-646-5288 or visit us online at ninjakitchen.com



@ninjakitchen

CM401_QSG_IG_MP_MV6

© 2019 SharkNinja Operating LLC

NINJA is a registered trademark of SharkNinja Operating LLC.
NINJA SMART SCOOP is a trademark of SharkNinja Operating LLC.